

RECYCLING PASSPORT

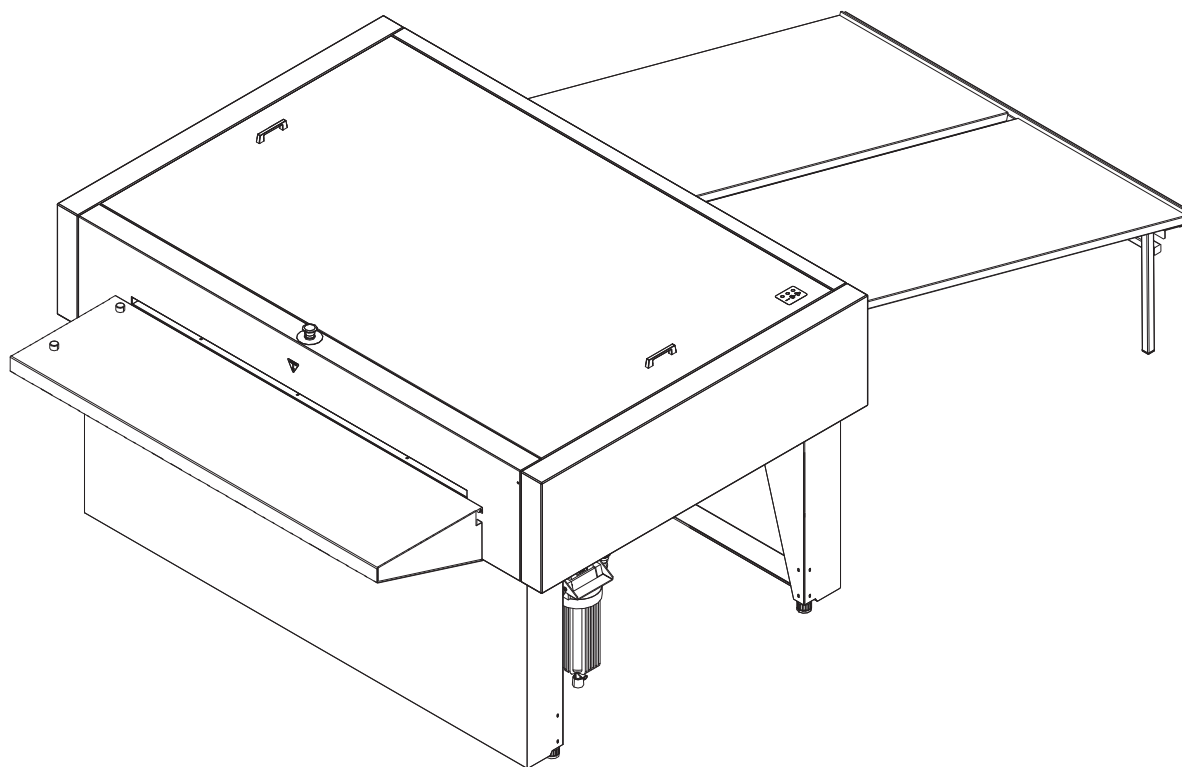

T11279

Model EL125T

The equipment described in this document should be disposed at a certified appliance recycling centre or processing centre.

This document is published by:

GLUNZ & JENSEN A/S
Haslevvej 13
DK-4100 Ringsted
Denmark
Phone: +45 57 68 81 81
E-mail: gjhq@glunz-jensen.com
Internet: www.glunz-jensen.com

Edition AA, April 2011
This document has part No 10061685

Recycling Passport

1. General view

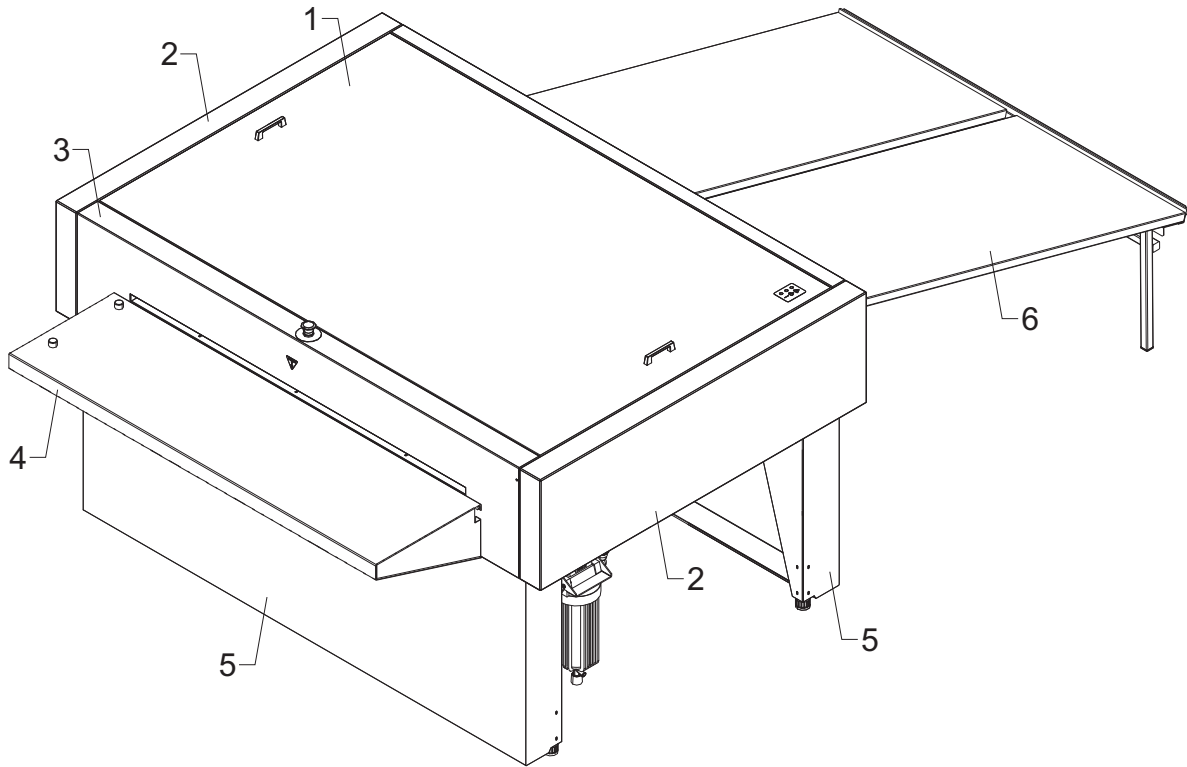

T32037

No	Material	Important notes
1	Aluminium	Top panel (painted surface)
2	Ferro magnetic steel	Side fenders (painted surface)
3	Ferro magnetic steel	Front panel (painted surface)
4	Ferro magnetic steel	Feed table (painted surface)
5	Ferro magnetic steel	Stand panels (painted surface)
6	Ferro magnetic steel	Exit table (painted surface)

2. Notes for dismantling materials/components, that can disturb certain recycling processes, and materials through which benefits can normally be achieved

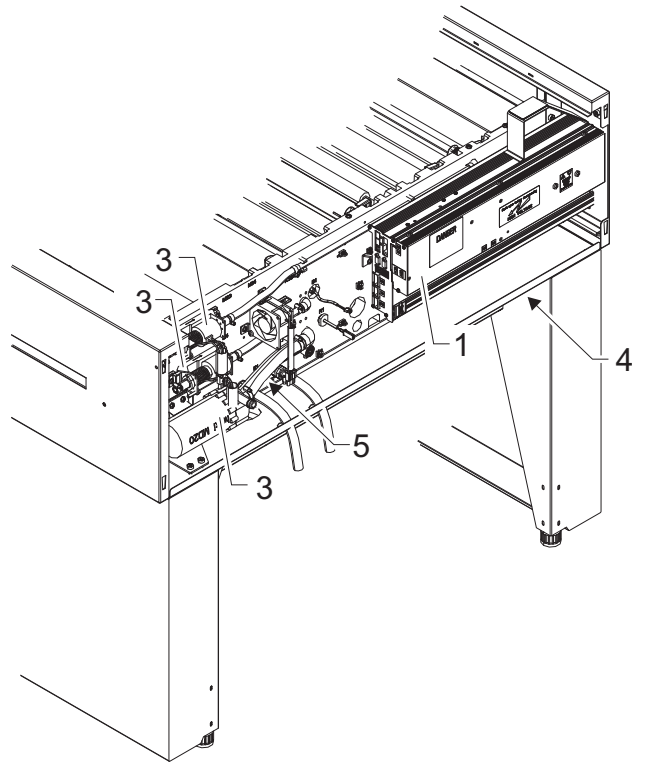
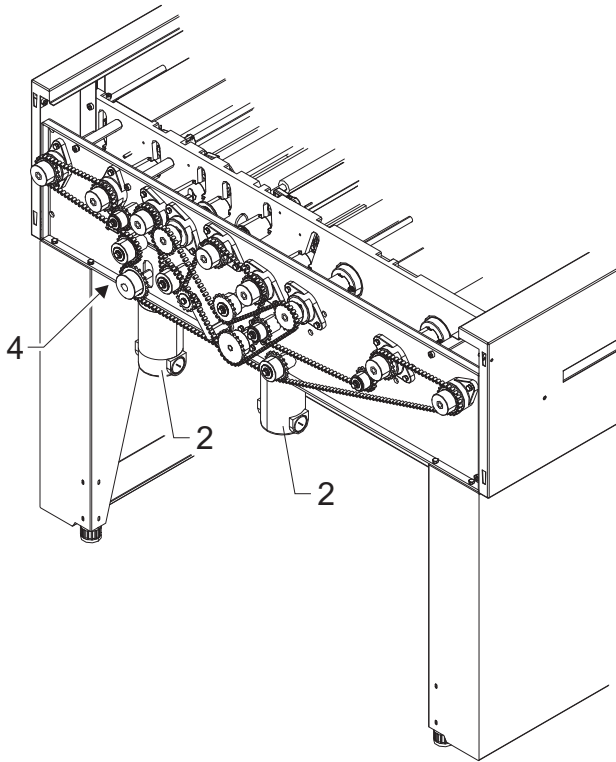

T32038

No	Material	Important notes
1	Electronics cabinet with PCB and cables	Remove the right fender by unscrewing 2 screws. Disconnect the plugs from the electronics cabinet. Unscrew 4 screws from lid of electronics cabinet and open it. Disconnect all plugs, strips and PCB. Unscrew 2 screws from the bottom side of cabinet and remove it.
2	Motors	Remove the left fender. Motors are fixed on the drive plate. Disconnect the motor plugs. Unscrew the screws holding the motors and remove them.
3	Pumps	Remove the right fender. Remove the tubes from the pumps taking care not to spill chemicals. Remove the plugs. The pumps are fixed by screws to the tank wall or to the pump bracket.
4	Dryer blowers and heaters	Remove the top and the dryer covers. Remove airducts and guides from the dryer section. Disconnect the plugs for the fans. Unscrew the left and right fans and remove the fans with blowers and heaters.
5	Developer section heater	Remove right fender. In the developer section remove the brush roller and guide section, then remove the heater by pulling out the plug and unscrewing the nut.

Recycling Passport

3. Recycling data

1. Materials/components which must be removed and treated separately

Material/recycling codes	Weight (kg)	Components/assemblies and notes
Chemical R134A	0.17	Contents in chiller unit

2. Materials/components which can disturb certain recycling processes

Material/recycling codes	Weight (kg)	Components/assemblies and notes
PCB - Circuit boards	2.5	In the electronics cabinet on right side of processor
Mixed metals	10	Screws, washers, locking clips etc.
Mixed plast materials	6.5	Lids, stand pipes
Subtotal	19	

3. Materials/components through which benefits can normally be achieved

Material/recycling codes	Weight (kg)	Components/assemblies and notes
Stainless steel	43	Guides, shafts, brackets
Aluminium	22	Panels, covers, airducts
Cables/wires	5.5	
POM	1.6	Gears, bearings, worms
PVC	47	Covers, etc.
PP	1	Tank, covers, tubes
Ferro magnetic steel	186	Brackets, stand, frame, support
Motor & pumps	17	
Heating element	0.6	
PA	1	Bearings, hinges, misc. small parts
Brass	0.5	Screws and stays
Subtotal	325.2	

4. Materials/components which cannot be separated into monomaterials destructively by mechanical processes (composite materials)

Material recycling characteristics	Weight (kg)	Components/assemblies and notes
Mixed metal and plastic materials (misc. small parts)	10.3	Fittings, hoses, springs, brackets, filter
Rubber	18	Rollers
Subtotal	28.3	