

## Wet end set

See the separate instruction for installation of the Wet end set.

- Install the Wet end set on the developer circulation pump.

# Instruction

## Preventive Maintenance Kit Medium Plate Processors Thermal

### **IMPORTANT!**

Please keep this instruction with other machine documentation as future reference when ordering spareparts. The spareparts concerning this kit are as listed in "KIT CONTENTS".

**Part No 10062252 D**

**30-04-2014**

# Introduction

This instruction is valid for **Kit nos 10062181 and 10062201** (Cannot be ordered separately).

## Products covered

The above mentioned preventive maintenance kits are for the following processors:

**Plate Processors 68 Thermal** serial nos 94866, 95094, 92261, 95426, 92510, 10061411, 92540, 92541, 92542, 92547, 92548, 92638, 92640, 92707, 92712, 93119, 93378, 93379, 10062804, 10062806, 10065404, 10063008, 10063048.

**Plate Processors 85 Thermal** serial nos 95397, 95508, 94867, 91801, 92639, 95433, 92511, 10061407, 92521, 92536, 92544, 92546, 92549, 92550, 92551, 92552, 92553, 92562, 92563, 92639, 92641, 92642, 92708, 92709, 92713, 93120, 93377, 93380, 93390, 10062012, 10062805, 10063047, 10065403.

**⚠** Verify that the serial number specified on the processor name plate located on the rear end of the tank on the left side is listed above.

## Kit contents

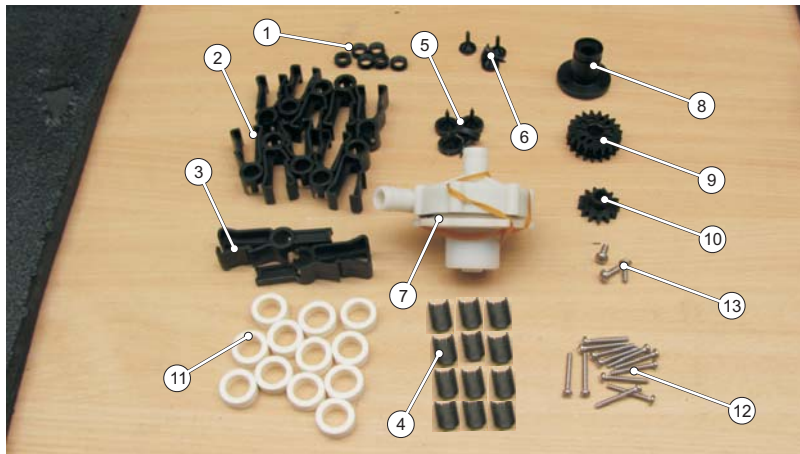

**i** Not all models!

- Dismount the screws (o) and remove the gears (p, q) from the brush gear shaft.
- Replace the gears.

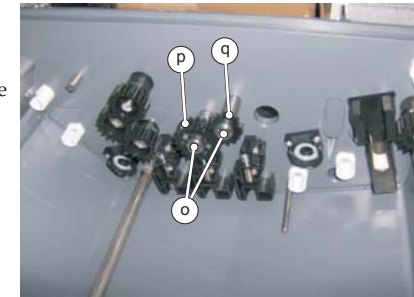

- Pull out the rear developer spray tube (r).
- Take off the clips (s), remove the guides (t) and replace them.

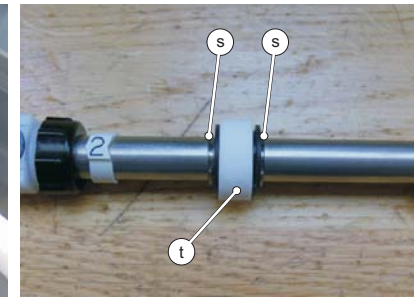
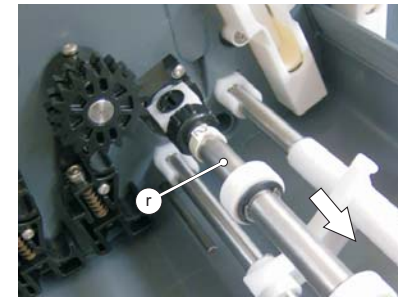

## Replacing valves

- Disconnect the cables from the connector (u).
- Loosen the clamps (v) to remove the hoses.
- Dismount the screws (x) to remove pump from the bracket.
- Dismount the elbow fittings (y) from the pump.
- Replace the poppet valves (z) inside the pump head with identical ones.
- Remount the elbow fittings, remount the pump onto the bracket and reconnect the hoses and cables. Reuse and tighten the clamps.

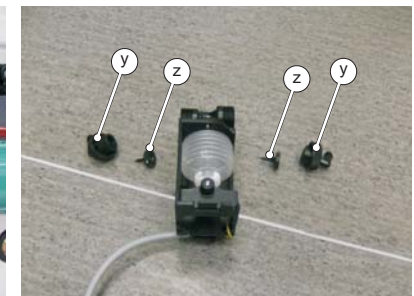
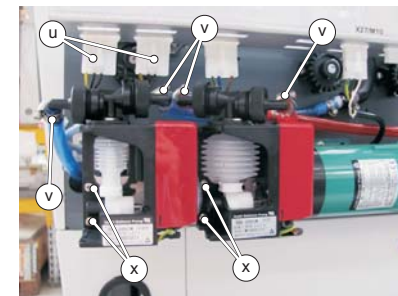

## Replacing drive parts

- Remove all rollers, brushes and brackets so there is easy access to all gears, remove the fenders, dismount the drive shaft and the brush motor.
- Take off and replace the clip (c), gear (d), and v-seal (e) on the shaft with gears.

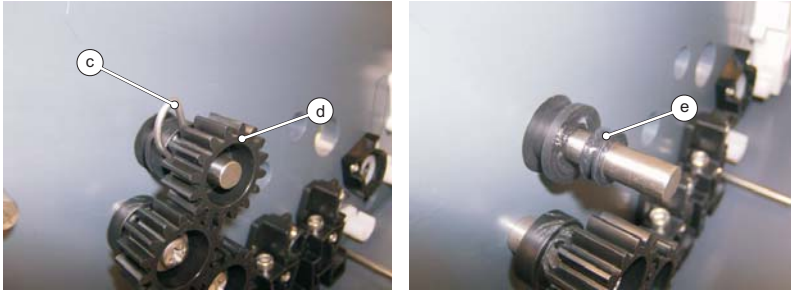

- Dismount the screws (f) that hold the brush bearing (g) on the tank.
- Replace the shell bearing (h). Use the new screws (12) when mounting the bearing.

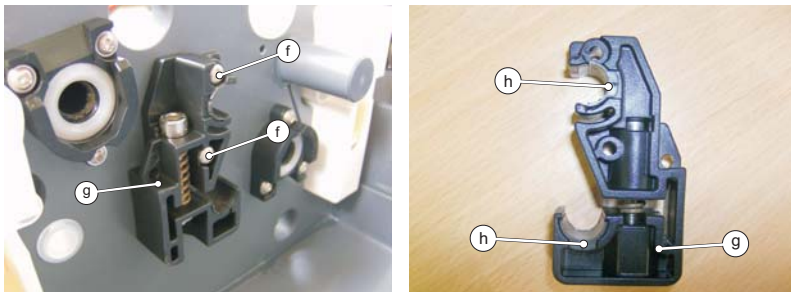

- Take off the clip (i) and remove the gear (j). Dismount the screw (k) to remove the bearing seal (l). Pull out the shaft.
- Dismount the screws (m) to remove the drive bearing (n).
- Replace the drive brush bearing together with the v-seal and bearing seal. Use the new screws (13) when mounting the bearing.

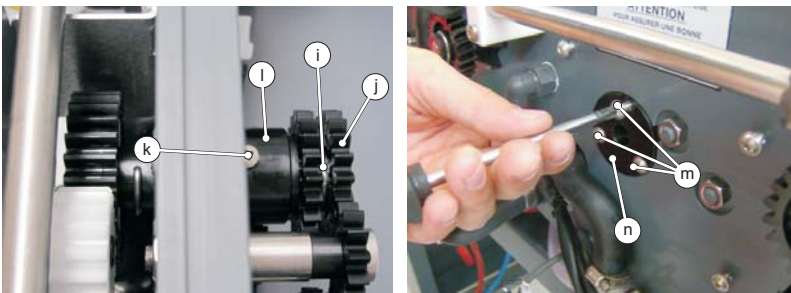

Check contents of the kit and make sure that all parts are present and in good condition.

The kit consists of:

Item	Number	Specification	Quantity	
			10062181	10062201
1	6520	GROMMET, V-SEAL	6	6
2	43600	BEARING, ROLLER, SNAP, BLACK	10	10
3	10013520	BEARING, ROLLER, SNAP	2	2
4	10008621	SHELL, BEARING	12	12
5	10003917	VALVE, POPPET, ASSEMBLY, PUMP	4	-
6	15808	VALVE, PUMP, OSC.	2	4
7	10060921	WET END SET, MD20	1	-
	10063831	WET END SET, MD15	-	1
8	10022265	BEARING, DRIVE, BRUSH	1	1
9	73262	GEAR, Z19, M2, D12	1	1
10	10052400	GEAR Z13 D10/28X6 M=2	1	1
11	10004646	GUIDE, SILICONE	12	12
12	45933	SCR KB 40x30 WN1412 A4	12	12
13	45772	SCREW, D5X14, CR, FLG, KB, WN1411	3	3

## Estimated time



Estimated time for the installation of the kit is 180 - 240 minutes.

## Maintenance intervals

- i** Carry out this maintenance procedure either after below specified processing hours, or after specified years after installation of the processor, whatever comes first.

Processing hours	or	Years after installation	Maintenance	Kit no	
				Raptor	Gecko 85
500	or	1	MINOR	10062183	10062202
1000	or	2	MEDIUM	10062184	10062203
1500	or	3	MINOR	10062183	10062202
2000	or	4	MAJOR	10062185	10062204
2500	or	5	MINOR	10062183	10062202
3000	or	6	MEDIUM	10062184	10062203
3500	or	7	MINOR	10062183	10062202
4000	or	8	MAJOR	10062185	10062204
4500	or	9	MINOR	10062183	10062202
5000	or	10	MEDIUM	10062184	10062203
5500	or	11	MINOR	10062183	10062202
6000	or	12	MAJOR	10062185	10062204

## Before installation

Read this instruction sheet carefully and ensure it is fully understood before commencing the installation procedure. Seek clarification of anything that is not clear.

- h** The exchange procedure must only be carried out by a well qualified service technician who is familiar with the equipment.

- i** Install the Preventive Maintenance Kit Minor together with this kit.

- i** Installation of this kit is required as a part of Preventive Maintenance Kit Major.

## Safety

- !** Before any work is carried out, ensure that the processor is switched off, and disconnected from the electricity supply. It is recommended that the mains supply be locked off using a padlock or similar, and then a check made to ensure that the processor will not run.

## Procedure

### Replacing bearings

- Open the top covers, empty the tank into waste containers.
- Compress the bearing (a) to release the roller and replace the bearing.

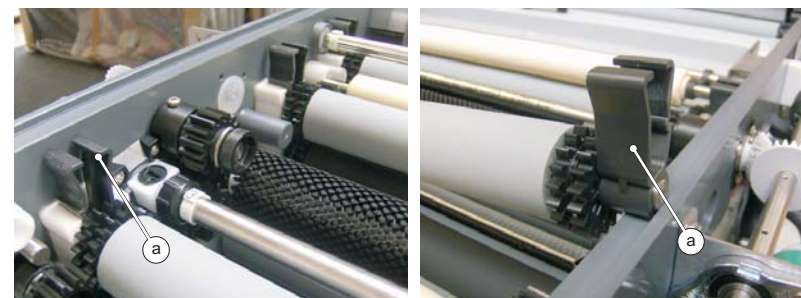

- Compress the bearing in the dryer section (b) to release the roller and replace the bearing.

