

Instruction



Preventive Maintenance Kit Minor Plate Processors Polymer

IMPORTANT!

Please keep this instruction with other machine documentation as future reference when ordering spareparts. The spareparts concerning this kit are as listed in "KIT CONTENTS".

Part No 10066081 B

29-04-2014

Introduction

This instruction is valid for **Kit nos 10066119 and 10066129** (Cannot be ordered separately).

Products covered

The above mentioned preventive maintenance kits are for the following processors:

Plate Processors 85 Polymer serial nos 90125, 90127, 90131, 90144, 91235, 91276, 91278, 91280, 91307, 91343, 91352, 91363, 91364, 91472, 91482, 91503, 91508, 91606, 92072, 92356, 92364, 92446, 92472, 92564, 92844.

Plate Processors 135 Polymer serial nos 90132, 90136, 90140, 91470, 91517, 94289.



Verify that the serial number specified on the processor name plate located on the rear end of the tank on the left side is listed above.

Kit contents

Check contents of the kit and make sure that all parts are present and in good condition.

The kit consists of:

Item	Number	Specification	Quantity	
			10066131	10066143
1	10046059	MILLED, BEARING, ROLLER, D54	52	20
2	10046055	MILLED, BEARING, ROLLER, D69	-	32
3	35483	V-RING, VA20, NBR	1	1
4	25817	O-RING D78X3, EPDM	2	2
5	25387	GREASE, TUBE, PG 75, 20 ML	1	1
6	10062064	GREASE, LUBRICANT, 100 ML	1	1
7	10066081	INSTRUCTION (THIS DOCUMENT)	1	1

Estimated time



Estimated time for the installation of the kit is 30 minutes.

Lubrication of preheat bearings



The bearings need to be greased once a year (or if they start to “squeak”). The bearings may squeak already after a few months depending on the room condition - if the humidity is too low.

Replacing o-ring

i The o-rings to be replaced is located on the right side of the processor next to the control panel.

- Open the filter (i).
- Replace the o-ring (j).
- Remount the filter.

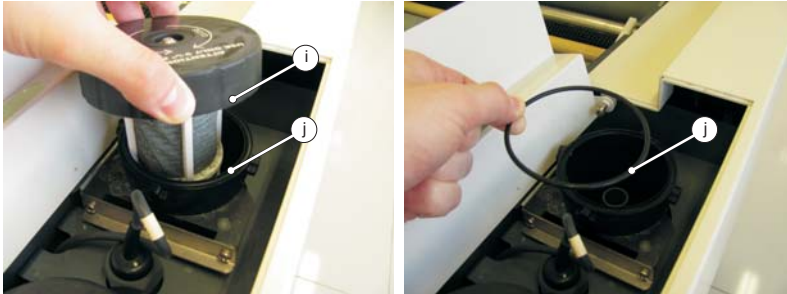

- Open the drain lid.
- Replace the o-ring. (k).
- Close the lid.



Maintenance intervals

i Carry out this maintenance procedure either after below specified processing hours, or after specified years after installation of the processor, whatever comes first.

Processing hours	or	Years after installation	Maintenance	Kit no	
				85	135
1500	or	1	MINOR	10066131	10066143
3000	or	2	MEDIUM	10066130	10066142
4500	or	3	MINOR	10066131	10066143
6000	or	4	MAJOR	10066126	10066116
7500	or	5	MINOR	10066131	10066143
9000	or	6	MEDIUM	10066130	10066142
10500	or	7	MINOR	10066131	10066143
12000	or	8	MAJOR	10066126	10066116

Before Installation

Read this instruction sheet carefully and ensure it is fully understood before commencing the installation procedure. Seek clarification of anything that is not clear.

Hand icon The exchange procedure must only be carried out by a well qualified service technician who is familiar with the equipment.

i Installation of this kit is required as a part of Preventive Maintenance Kit Medium and/or Preventive Maintenance Kit Major.

Safety

Warning icon Before any work is carried out, ensure that the processor is switched off, and disconnected from the electricity supply. It is recommended that the mains supply be locked off using a padlock or similar, and then a check made to ensure that the processor will not run.

Procedure

Replacing brush/roller bearings

- Turn off the processor, open the top covers, empty the tank into waste containers.
- Release the locks (a) on all rollers and locks on the brushes (b).

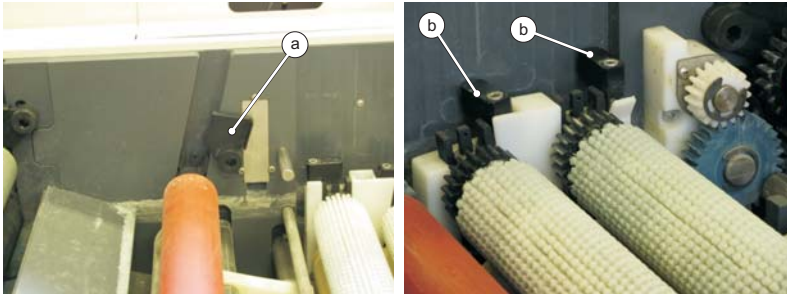

- Remove the roller or the brush from the tank. Take off the old roller bearings (c) and replace them.
- All lower bearings in 135 models are to be replaced with item 2 from the kit contents.

i If the Preventive Maintenance Kit Medium is to be installed as well, refer to the relevant instruction for replacement of the brush gears.

i The correct position of each roller and brush is shown on a label underneath the top cover. See also Installation manual for the reference.

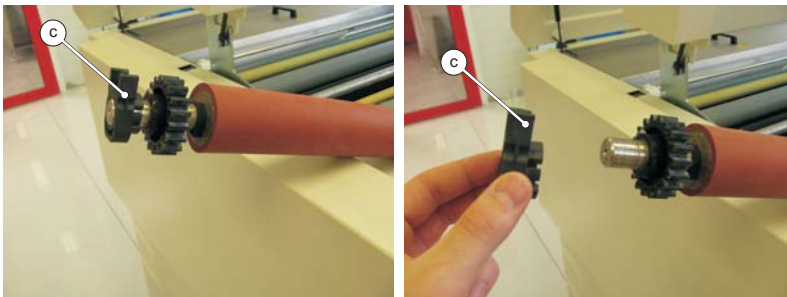

Replacing v-ring

i The v-ring to be replaced is located inside the brush bearing in the developer section.

- Take off the circlip (d) from the gear on the brush bearing in the developer section.
- Remove the gear (e).
- Dismount the two screws (f) to remove the bearing seal (g).

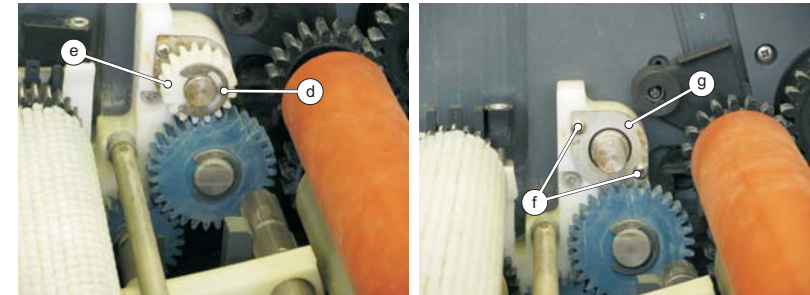

- Remove the v-ring (h) by means of a screwdriver and replace it.

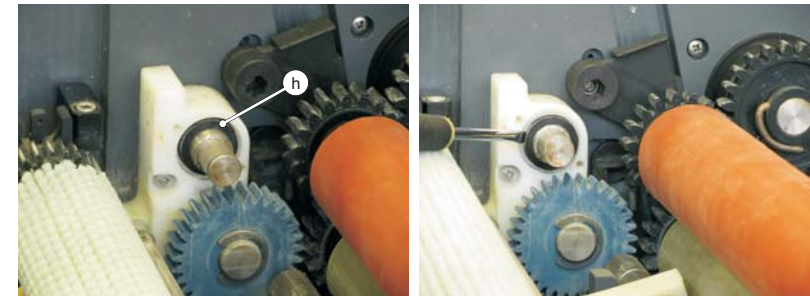

i If the Preventive Maintenance Kit Medium is to be installed as well, refer to the relevant instruction for replacement of the gear.

- Remount the seal, place back the gear and secure it with the circlip.