

Instruction



Preventive Maintenance Kit Minor Plate Processors Thermal

IMPORTANT!

Please keep this instruction with other machine documentation as future reference when ordering spareparts. The spareparts concerning this kit are as listed in "KIT CONTENTS".

Part No 10066084 B

30-04-2014

Introduction

This instruction is valid for **Kit nos 10066115 and 10066125** (Cannot be ordered separately).

Products covered

The above mentioned preventive maintenance kits are for the following processors:

Plate Processors 85 Thermal serial nos 90117, 90119, 90123, 90137, 90139, 90145, 90147, 91204, 91469, 91471, 91476, 91584, 91610, 91714, 91716, 92073, 92078, 92079, 92530, 92531, 92538, 92539, 92557, 93109, 93382, 94100, 94150.

Plate Processors 135 Thermal serial nos 90013, 90014, 90018, 90120, 90138, 90143, 90148, 91160, 91205, 91612, 91708, 91715, 91717, 91719, 91720, 92529, 92532, 92558, 92560, 92671, 93110, 93381, 93383, 93654, 94101, 94151.



Verify that the serial number specified on the processor name plate located on the rear end of the tank on the left side is listed above.

Kit contents

Check contents of the kit and make sure that all parts are present and in good condition.

The kit consists of:

Item	Number	Specification	Quantity	
			10066141	10066145
1	10046059	MILLED, BEARING, ROLLER, D54	16	44
2	10046055	MILLED, BEARING, ROLLER, D69	24	-
3	35483	V-RING, VA20, NBR	1	1
4	25817	O-RING D78X3, EPDM	2	2
5	25387	GREASE, TUBE, PG 75, 20 ML	1	1
6	10066084	INSTRUCTION (THIS DOCUMENT)	1	1

Estimated time



Estimated time for the installation of the kit is 30 minutes.

Replacing o-ring

i The o-rings to be replaced is located on the right side of the processor next to the control panel.

- Dismount the housing filter (i) by means of the filter key (j).
- Replace the o-ring (k).
- Remount the housing filter.

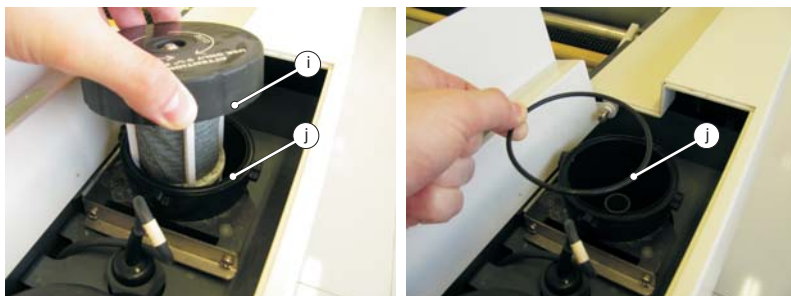

- Open the drain lid.
- Replace the o-ring (k).
- Close the lid.



Maintenance intervals

i Carry out this maintenance procedure either after below specified processing hours, or after specified years after installation of the processor, whatever comes first.

Processing hours	or	Years after installation	Maintenance	Kit no	
				85	135
1500	or	1	MINOR	10066145	10066141
3000	or	2	MEDIUM	10066144	10066140
4500	or	3	MINOR	10066145	10066141
6000	or	4	MAJOR	10066120	10066112
7500	or	5	MINOR	10066145	10066141
9000	or	6	MEDIUM	10066144	10066140
10500	or	7	MINOR	10066145	10066141
12000	or	8	MAJOR	10066120	10066112

Before Installation

Read this instruction sheet carefully and ensure it is fully understood before commencing the installation procedure. Seek clarification of anything that is not clear.

h The exchange procedure must only be carried out by a well qualified service technician who is familiar with the equipment.

i Installation of this kit is required as a part of Preventive Maintenance Kit Medium and/or Preventive Maintenance Kit Major.

Safety

! Before any work is carried out, ensure that the processor is switched off, and disconnected from the electricity supply. It is recommended that the mains supply be locked off using a padlock or similar, and then a check made to ensure that the processor will not run.

Procedure

Replacing brush/roller bearings

- Turn off the processor, open the top covers, empty the tank into waste containers.
- Release the locks (a) on all rollers and locks on the brushes (b).

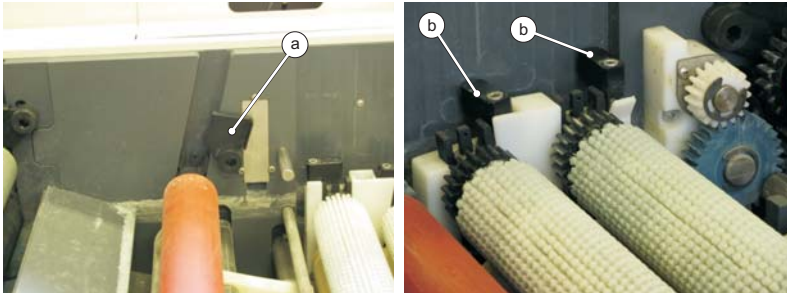

- Remove the roller or the brush from the tank. Take off the old roller bearings (c) and replace them.
- All lower bearings in 125/150 models are to be replaced with item 2 from the kit contents.

i If the Preventive Maintenance Kit Medium is to be installed as well, refer to the relevant instruction for replacement of the brush gears.

i The correct position of each roller and brush is shown on a label underneath the top cover. See also Installation manual for the reference.

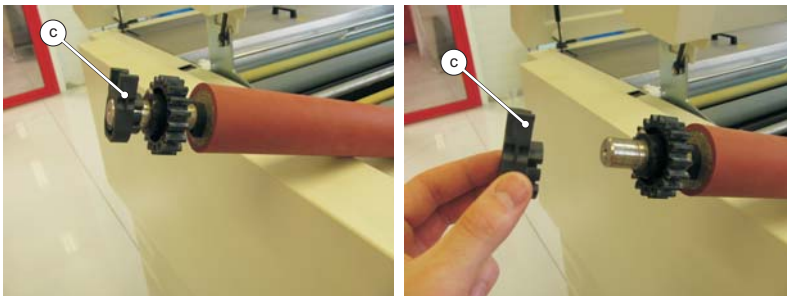

Replacing v-ring

i The v-ring to be replaced is located inside the brush bearing in the developer section.

- Take off the circlip (d) from the gear on the brush bearing in the developer section.
- Remove the gear (e).
- Dismount the two screws (f) to remove the bearing seal (g).

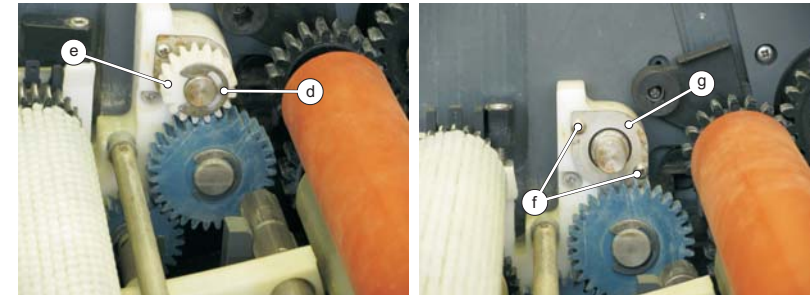

- Remove the v-ring (h) by means of a screwdriver and replace it.

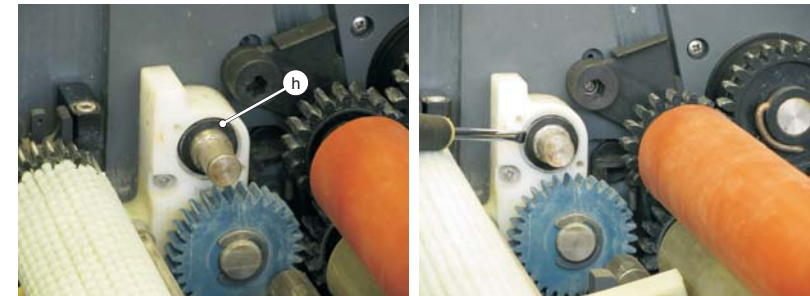

i If the Preventive Maintenance Kit Medium is to be installed as well, refer to the relevant instruction for replacement of the gear.

- Remount the seal, place back the gear and secure it with the circlip.